

# TOP 2023 NEW ITEMS

GM & FORD ADDITIONS

\*Photos actual size\*

PAGE 1 OF 8

**25343**  
Tail Lamps & Side Body

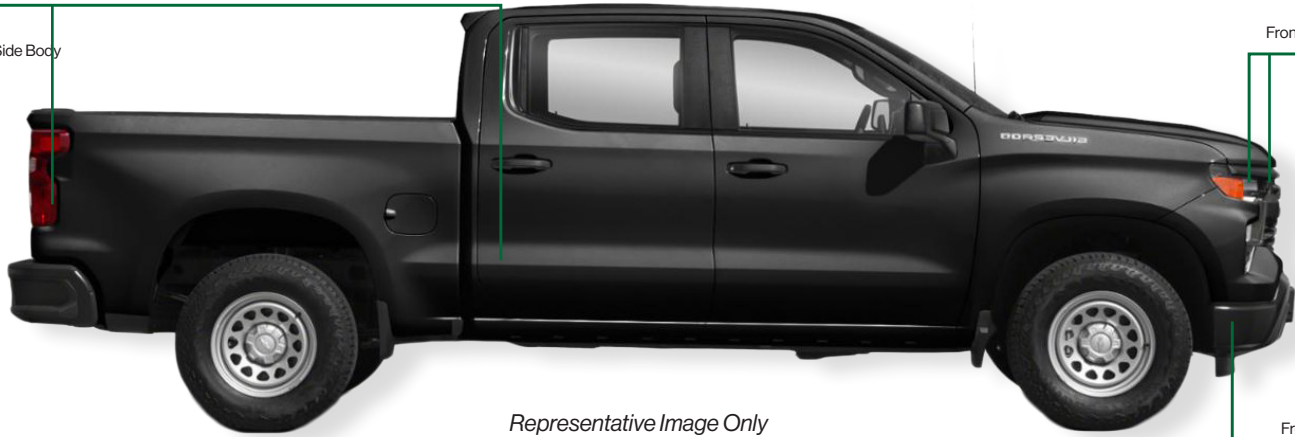

Representative Image Only

**25416**  
Front Lamps, Grille

**25416**  
Front Bumper



**25416**



**25416**

Auveco Part No.	O.E.M. Number	Product Description	Unit Pkg.	Catalog Page
<b>25416</b>	11603057	<b>Front Bumper Retainer</b>	25	615
<b>25343</b>	11571063	<b>Tail Lamp Retainer with Sealer</b>	25	508

See page 6 for application data

**25326**  
Rear Door

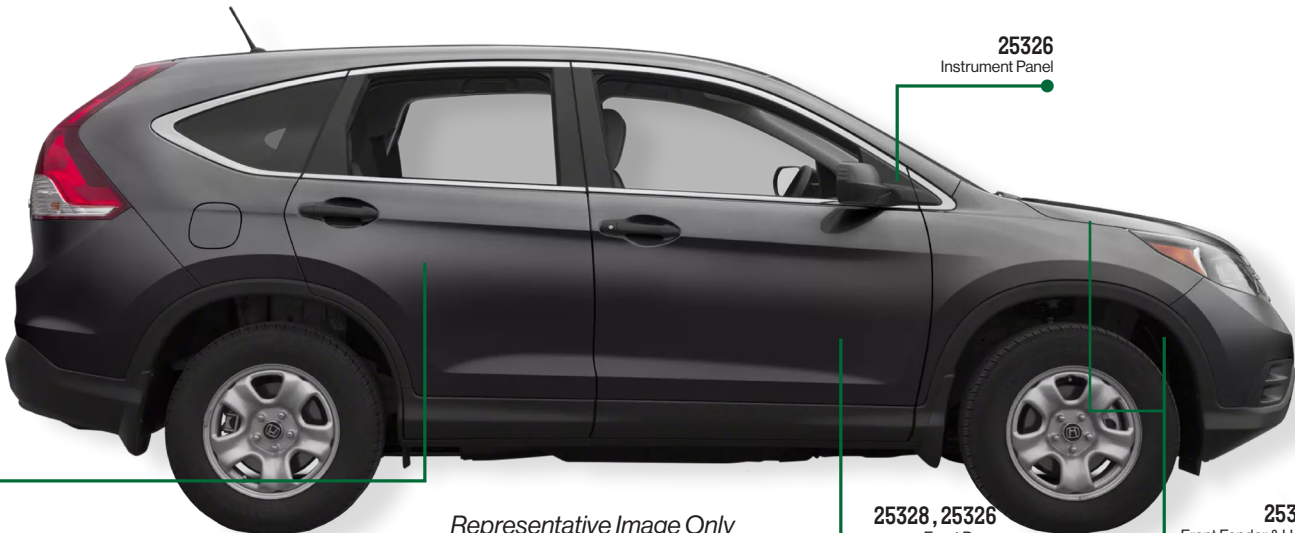

Representative Image Only

**25326**  
Instrument Panel

**25328, 25326**  
Front Door

**25328**  
Front Fender & Hood



**25326**



**25328**

Auveco Part No.	O.E.M. Number	Product Description	Unit Pkg.	Catalog Page
<b>25328</b>	91532-SJA-003	<b>Fender Garnish Moulding &amp; Hood Seal Retaining Clip</b>	50	477
<b>25326</b>	90666-TA0-A01	<b>Door &amp; Interior Trim Panel Clip</b>	25	668

See page 6 for application data

# TOP 2023 NEW ITEMS

## FORD ADDITIONS

*\*Photos actual size\**

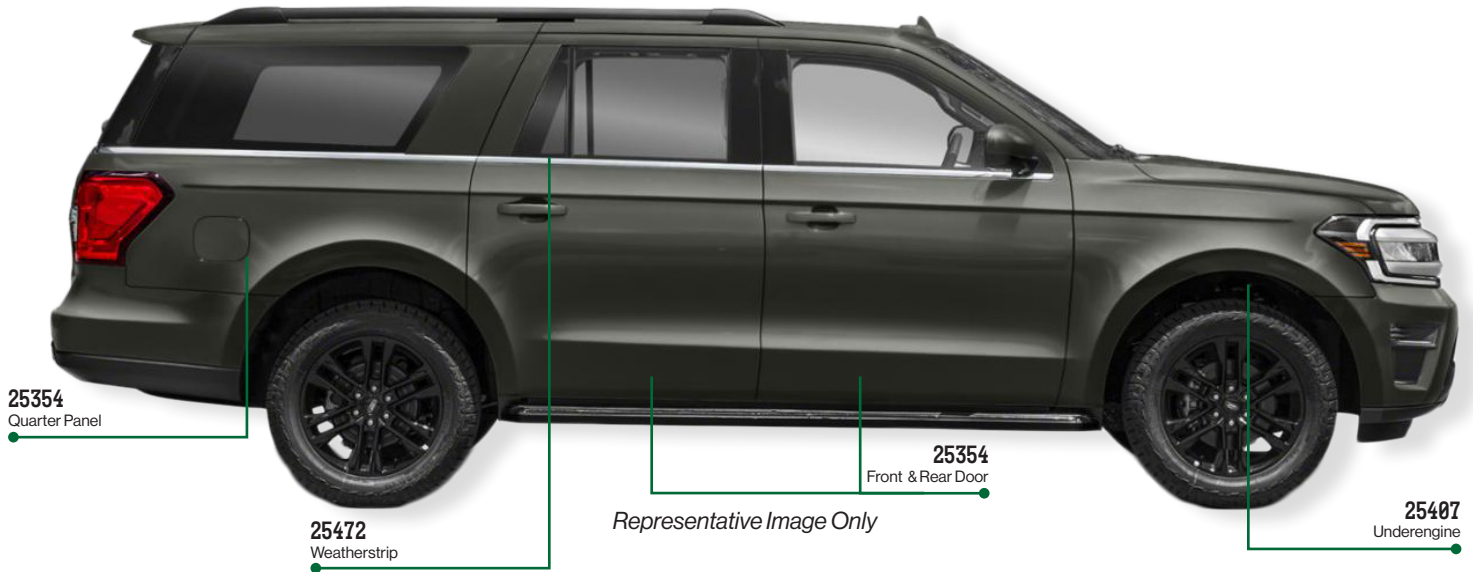

*Representative Image Only*



**25354**



**25472**



**25407**



**25474**

*\*Photo not actual size\**

Auveco Part No.	O.E.M. Number	Product Description	Unit Pkg.	Catalog Page
<b>25354</b>	W719209-S300	<b>"B" Pillar Moulding Clip with Sealer</b>	15	633
<b>25472</b>	Not Available from O.E.M.	<b>Rear Door Crew Cab Weatherstrip Retainer</b>	50	HNI-522
<b>25407</b>	W719534-S300	<b>Splash Shield Nut</b>	25	617
<b>25474</b>	KU5Z-14A163-C	<b>Cable Tie with Oval Tree Mount</b>	15	648

*See page 6 for application data*

# TOP 2023 NEW ITEMS

## CHRYSLER & RAM ADDITIONS

\*Photos actual size\*



25439



25418



25351



25417



25349



25324

Auveco Part No.	O.E.M. Number	Product Description	Unit Pkg.	Catalog Page
25439	68353367AA	Bumper & Grille Square Head Stud with Dog Point	25	80
25417	6510174AA	Fender Flare & Wheel Apron Hex Head Tapping Screw	50	HNI-520
25418	6510827AA	Fender Apron Hex Head Tapping Screw	50	HNI-520
25349	68499020AA	Rear Wheel Opening Moulding Clip	25	653
25351	68499019AA	Rear Wheel Opening Spat Clip	50	480
25324	68053681AA	Lower Bumper Deflector Push-Type Retainer	25	554

See page 6 for application data

# TOP 2023 NEW ITEMS

HYUNDAI & KIA ADDITIONS

*\*Photos actual size\**

PAGE 4 OF 8

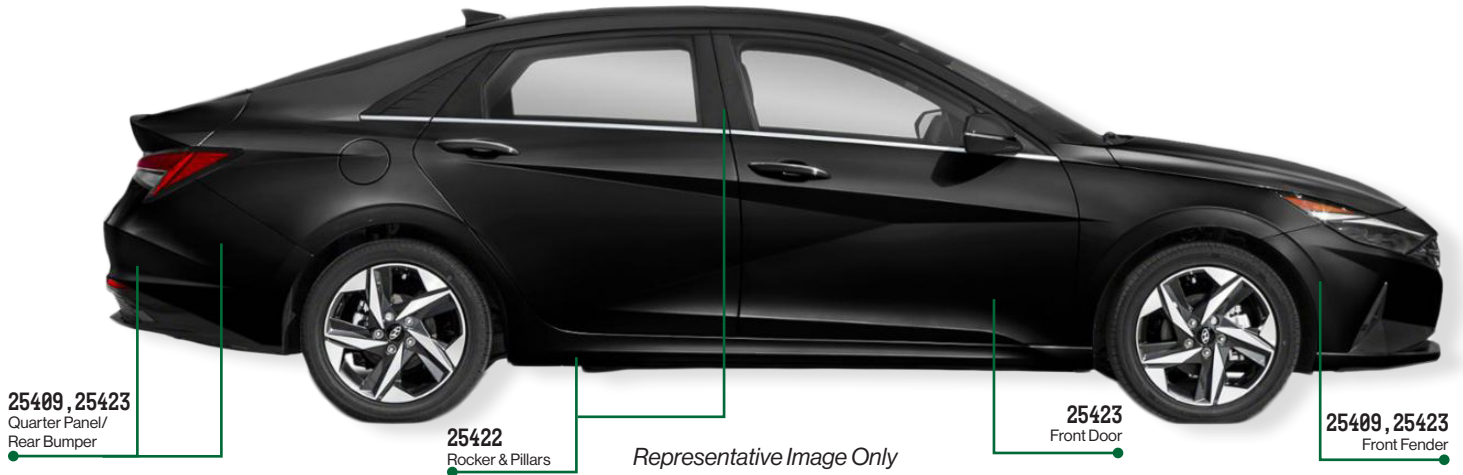

25409



25423



25422

Auveco Part No.	O.E.M. Number	Product Description	Unit Pkg.	Catalog Page
25409	12493-06257-E	Phillips Truss Washer Head Tapping Screw	25	44
25423	87758-G2000 87767-J9000	Rocker Moulding Retainer with Sealer	15	719
25422	14202-14120-B	Rocker Moulding Clip with Sealer	25	720

*See page 6 for application data*

# TOP 2023 NEW ITEMS

LEXUS & TOYOTA ADDITIONS

*\*Photos actual size\**

PAGE 5 OF 8

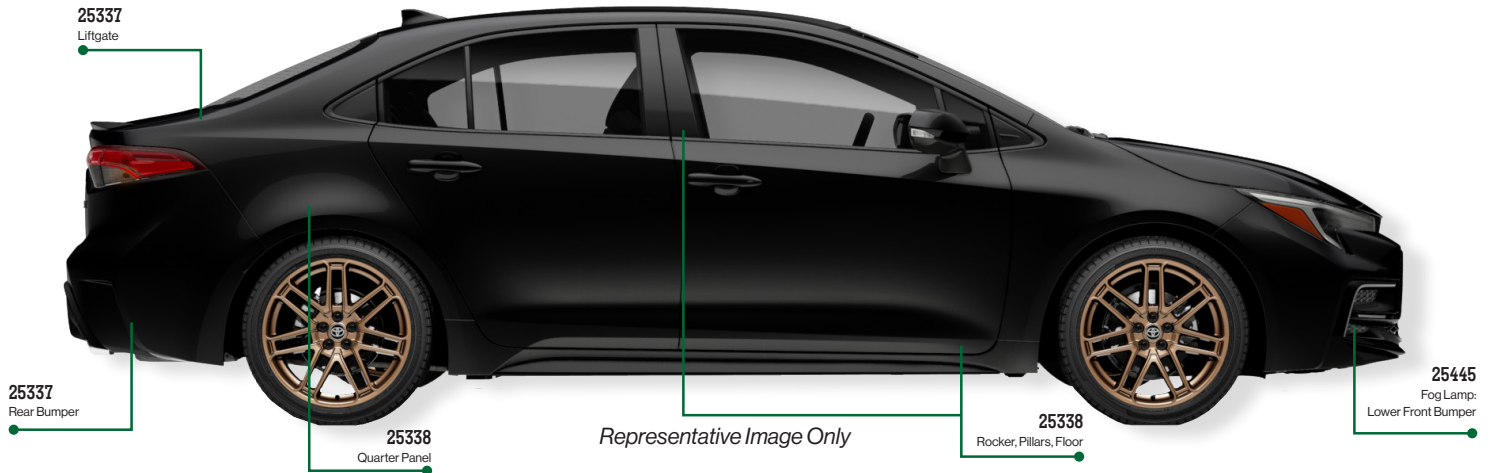

25455



25337



25338

Auveco Part No.	O.E.M. Number	Product Description	Unit Pkg.	Catalog Page
<b>25455</b>	90167-50063	<b>Fog Lamp Phillips Round Washer Head Thread Cutting Tapping Screw</b>	25	HNI-22
<b>25337</b>	76829-60020	<b>Interior Trim Panel Retainer</b>	50	480
<b>25338</b>	90467-07222	<b>Rocker Panel Moulding Push-Type Retainer</b>	25	548

*See page 6 for application data*

# TOP 2023 NEW ITEMS

## APPLICATION DATA

PAGE 6 OF 8

<b>25416</b>	Cadillac Escalade 2021 - On; Chevrolet Suburban, Tahoe 2021 - On; GMC Yukon 2021 - On; Hummer EV 2022 - On
<b>25343</b>	Buick Enclave 2020 - 2018, Encore 2013 - On; Cadillac CTS 2015 - 2011; Chevrolet Trailblazer 2021 - On, Trax 2015 - On, Volt 2019 - 2016; Pontiac Solstice 2009
<b>25354</b>	Ford Bronco Sport 2021 - On, Escape 2020 - On; Lincoln Continental 2020 - 2017, Corsair 2020 - On
<b>25472</b>	Ford F-150 2019 - On
<b>25407</b>	Ford Explorer & Lincoln Aviator 2020 - On
<b>25474</b>	Ford & General Purpose
<b>25439</b>	Jeep Gladiator 2020 - On; RAM 1500, 2500, 3500 2019 - On
<b>25417</b>	Chrysler Pacifica 2017 - On, Voyager 2020 - On; Dodge Dart 2016 - 2012; Jeep Cherokee 2018 - 2014, Compass 2021 - On, Gladiator 2020 - On, Wrangler 2018 - On; RAM Pickups 1500, 2500, 3500 2012 - On, 4500, 5500 Chassis Cab 2017 - 2013
<b>25418</b>	Chrysler 200 2017 - 2015; Dodge Dart 2013; Jeep Cherokee 2014 - On, Wrangler 2018 - On, Gladiator 2020 - On, Grand Wagoneer, Wagoneer 2022 - On; Ram 2500 2018 - On, 1500 Classic 2019 - 1500 2020 - 2018, 3500, 4500, 5500 2021 - 2018
<b>25349</b>	Ram 1500 2019 - On
<b>25351</b>	Ram 1500 2019 - On
<b>25324</b>	Ram 1500 2019 - On
<b>25328</b>	Acura NSX 2020 - 2017, RL 2012 - 2005, TLX 2020 - 2018; Honda CR-V 2016 - 2012
<b>25326</b>	Acura ILX 2020 - 2013, RLX 2020 - 2014, TLX 2020 - 2015, TSX 2014 - 2009; Honda Accord 2012 - 2008, Civic 2015 - 2012, Crosstour 2015 - 2010, Pilot 2012 - 2009
<b>25409</b>	Hyundai Elantra 2018 - 2011, Ioniq 2019 - 2017, Palisade 2021 - 2020, Santa Fe 2019 - 2013, Tucson 2020 - 2009; Kia Cadenza 2020 - 2017, Forte 2016 - 2014, Forte5 2018 - 2014, Rio 2017 - 2012, Sportage 2021 - 2010, Telluride 2021 - 2020
<b>25423</b>	Genesis GV70 2022, GV80 2022 - 2021; Hyundai Ioniq 2020 - 2017, Kona 2022 - 2018, Santa Fe 2020 - 2019, Palisade, Sonata 2020 - On; Kia K5 2021 - On, Telluride 2020 - On
<b>25422</b>	Genesis G80 2021 - On; Hyundai Sonata 2023 - 2020; Kia K5 2021 - On
<b>25455</b>	Lexus CT200h 2017 - 2011, ES250 2021, ES300h, ES350 2021 - 2013, GS F, RC300 2020 - 2016, GS Turbo, RS Turbo 2017, GS200t 2016, GS300 2019 - 2018, GS350 2020 - 2013, GS450h 2018 - 2013, GX460 2021 - 2010, HS250h 2012 - 2010, IS F 2014 - 2008, IS200t, RC200t 2017 - 2016, IS250 2015 - 2012, IS300 2021 - 2016, IS350 2021 - 2012, LC500, LC500h, LS500, LS500h, NX300, RX350L, RX450hL, UX200, UX250h 2021 - 2018, LS460 2017 - 2013, LS600hL 2016 - 2013, LX570 2021 - 2008, NX200t 2017 - 2015, NX300h, RC F, RC350 2021 - 2015, RX350, RX450h 2022 - 2010; Scion iM 2016, iQ 2015 - 2012, tC 2016 - 2011 Toyota 4Runner 2022 - 2010, Avalon, Tundra 2021 - 2013, Camry, RAV4 2021 - 2012, CHR, 2022 - 2014, Highlander 2021 - 2014, Land Cruiser 2021 - 2015, Matrix 2014 - 2009, Mirai 2022 - 2016, Prius 2021 - 2010, Sequoia 2021 - 2017, Sienna 2022 - 2011, Tacoma 2021 - 2011, Venza 2021 - 2009, Yaris 2018 - 2007
<b>25337</b>	Lexus NX300 2015 - On, Toyota RAV4 2019 - On, Camry 2018 - On, Prius 2016 - On
<b>25338</b>	Toyota Avalon 2019 - On, Camry 2018 - On, Prius 2016 - On

# TOP 2023 NEW ITEMS

## HEAVY DUTY RIVETS

*\*Photos actual size\**

PAGE 7 OF 8

## HEAVY-DUTY RIVETS

Introducing our new heavy duty rivet line, featuring three new rivet types perfect for a wide variety of applications:

- **Tri-Fold Blind Rivets:** Superior retention compared to standard pop rivets. Thanks to their increased surface area, these rivets ensure better retention, making them perfect for thinner metals without causing damage to the materials.
- **Interlocking Structural Rivet:** Exceptional performance, especially in scenarios demanding vibration resistance, structural strength, and multi-grip capabilities. With their multi-grip structural design, they not only provide a fully sealed joint but also guarantee vibration resistance, making them the go-to choice for strong and secure fastening solutions.
- **Monobolt® Style Rivet:** Designed for demanding safety and performance applications, offering an ideal solution for situations requiring a high-strength fastener with access from just one side. These blind rivets excel in creating fully sealed joints, ensuring reliability and durability.

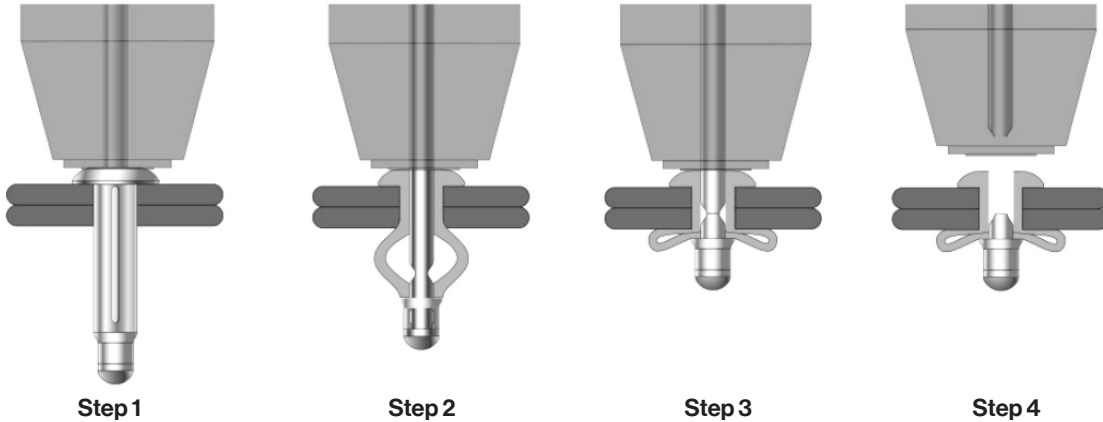

### TRI-FOLD BLIND RIVETS WITH RUBBER WASHER



- Aluminum rivet & mandrel
- Dome Head
- EPDM rubber washer provides watertight seal
- Used in recreational vehicle, heavy-duty truck, marine and general purpose applications

Auveco Part No.	Rivet Diameter	Grip Range	Head Diameter	Rivet Body Length (Excluding Head)	Unit Pkg.
25484	5.2mm	1.3mm - 4.8mm	11.6mm	17.9mm	50
25485	5.2mm	1.6mm - 6.4mm	11.6mm	19.5mm	50
25486	5.2mm	4.7mm - 9.5mm	11.6mm	22.6mm	50

# TOP 2023 NEW ITEMS

## HEAVY DUTY RIVETS

\*Photos actual size\*

### INTERLOCKING STRUCTURAL BLIND RIVETS



25487



25490



25488



25489



25491

- 304 stainless steel rivet and mandrel
- Large grip range
- High shear & tensile strength
- Excellent hole filling properties and vibration resistance
- Moisture resistant
- Used to fasten metal to metal and metal to plastic
- Used in automotive, heavy-duty truck, industrial, marine and recreational vehicle applications

Auveco Part No.	Head (Flange) Style	Rivet Diameter	Grip Range	Head Diameter	Unit Pkg.
25487	Dome	4.8mm	1.6mm - 11.1mm	10.2mm	50
25490	Countersunk	4.8mm	3.2mm - 8.4mm	9.2mm	50
25488	Dome	6.4mm	2.0mm - 9.5mm	13.5mm	25
25489	Dome	6.4mm	2.0mm - 15.9mm	13.5mm	25
25491	Countersunk	6.4mm	4.3mm - 12.1mm	11.4mm	25

### MONOBOLT® STYLE STRUCTURAL BLIND RIVETS



25492



25493



25495



25494



25496

- 304 stainless steel rivet and mandrel
- Large grip range
- High shear & tensile strength
- Excellent hole filling properties and vibration resistance
- Used to fasten metal to metal and metal to plastic
- Used in automotive, heavy-duty truck, industrial, marine and recreational vehicle applications
- Use with Auveco Nose Piece Nos. 21655 & 21656

Auveco Part No.	Head (Flange) Style	Rivet Diameter	Grip Range	Head Diameter	Unit Pkg.
25492	Dome	4.8mm	1.6mm - 6.5mm	10.1mm	50
25493	Dome	4.8mm	1.6mm - 11.0mm	10.1mm	50
25495	Countersunk	4.8mm	3.2mm - 8.4mm	9.0mm	50
25494	Dome	6.4mm	2.1mm - 9.5mm	13.4mm	25
25496	Countersunk	6.4mm	4.1mm - 12.1mm	10.2mm	25