

## Nylon Spacer Bushings (Stand-Offs)



Tough and resilient white nylon spacer bushings are ideal for use in electrical and electronic applications or anywhere a slip surface is needed. They can be used as bushings, bearings, rollers, glides or separators.

Auveco Part No.	I.D.	O.D.	Length	Unit Pkg.
<b>16198</b>	.257"	1/2"	1/4"	100
<b>16200</b>	.257"	1/2"	3/8"	100
<b>16202</b>	.257"	1/2"	1/2"	100
<b>16204</b>	.257"	1/2"	5/8"	100
<b>16205</b>	.257"	1/2"	3/4"	100
<b>16207</b>	.257"	1/2"	1"	100

## Standard Insulating Bushings

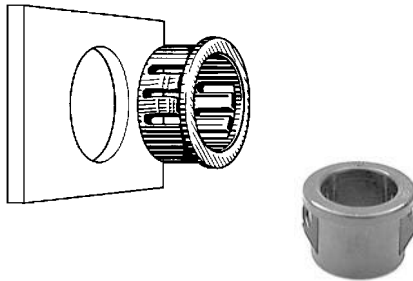

Nylon bushings designed to protect wires, cables, tubing, etc. from sharp, unfinished panel edges. Each size bushing employs multiple lock features to positively snap into panels ranging from 1/32" to 1/8" thickness. Available in both black and white nylon.

Auveco Part No.		Dimensions			Panel Hole Dia.	Unit Pkg.
Black Nylon	White Nylon	Inside Dia.	Head Dia.	Thick-ness		
<b>16087</b>	· · ·	1/4"	15/32"	13/32"	3/8"	50
<b>16088</b>	· · ·	3/8"	37/64"	13/32"	1/2"	50
<b>16089</b>	· · ·	7/16"	21/32"	13/32"	9/16"	50
<b>16090</b>	· · ·	1/2"	23/32"	13/32"	5/8"	50
<b>16091</b>	· · ·	5/8"	27/32"	13/32"	3/4"	50
<b>16092</b>	· · ·	11/16"	61/64"	29/64"	7/8"	50
<b>16093</b>	· · ·	3/4"	1-1/8"	29/64"	1"	50
<b>16094</b>	· · ·	15/16"	1-7/32"	29/64"	1-3/32"	50
<b>16095</b>	<b>16107</b>	15/16"	1-23/64"	29/64"	1-1/4"	50
<b>16096</b>	<b>16108</b>	1-5/16"	1-39/64"	29/64"	1-1/2"	25
<b>16097</b>	· · ·	1-5/8"	2-1/8"	29/64"	2"	25

## All-Fit Adjustable Bushings



Black nylon "ALL-FIT" Adjustable Bushings are designed to protect wire, cable, tubing or irregular shaped items from sharp, unfinished edges. The specially designed resilient multiple supports absorb shock and vibration, and adjust to accept various diameters and shapes. The ALL-FIT Bushing is equipped with multiple locks to positively snap in panel thicknesses ranging from 1/32" to 1/8"

Auveco Part No.	Panel Hole Dia.	Bushing Dimensions			Unit Pkg.
		Head Dia.	Thick-ness	Max. I.D.	
<b>16564</b>	5/8"	23/32"	13/32"	7/16"	50
<b>16565</b>	3/4"	55/64"	25/64"	1/2"	50
<b>16567</b>	7/8"	15/16"	29/64"	9/16"	50
<b>16568</b>	1"	1-1/16"	29/64"	3/4"	50